

# S2 Access Control System Setup

1. Open the group properties.

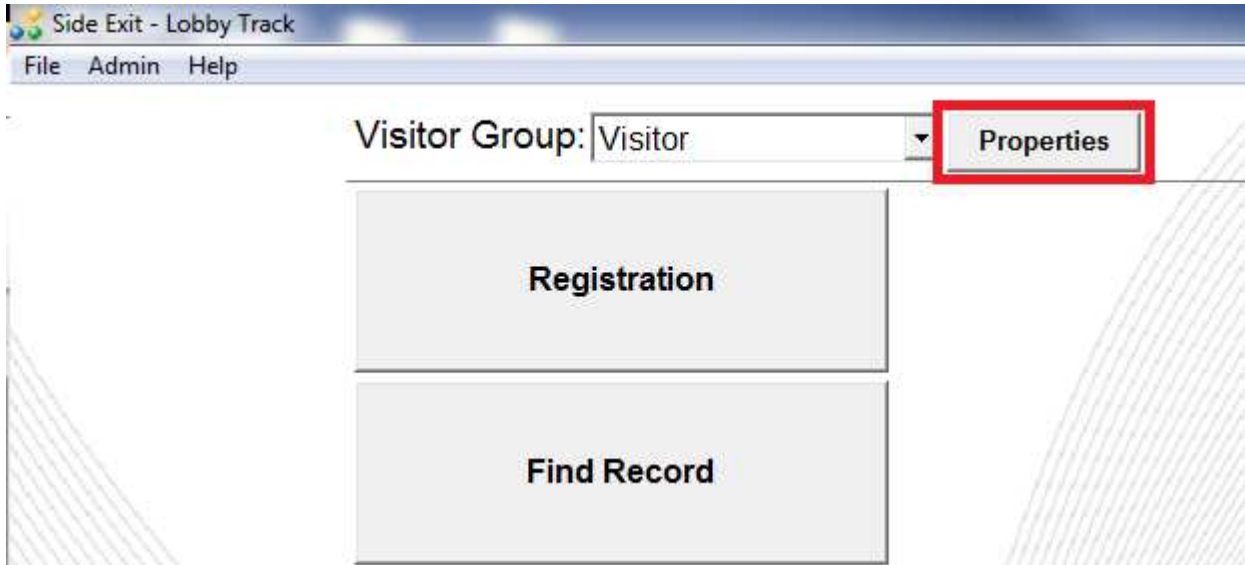

2. Open the Registration tab.

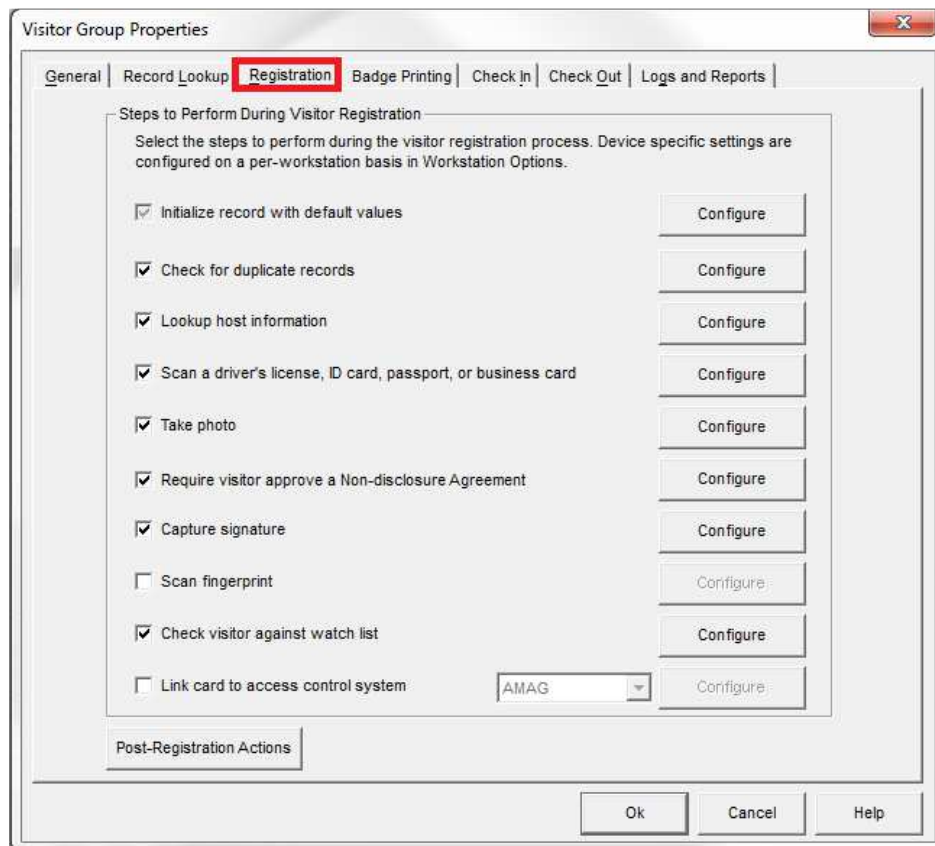

3. Select the 'Link card to access control system' option.

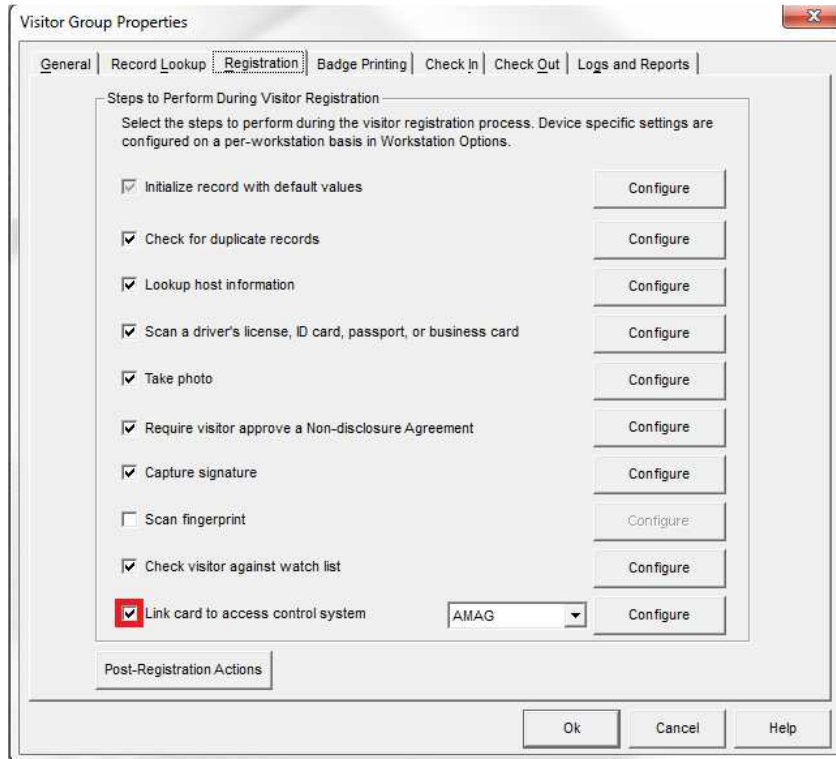

4. Select S2 from the drop-down menu and click configure.

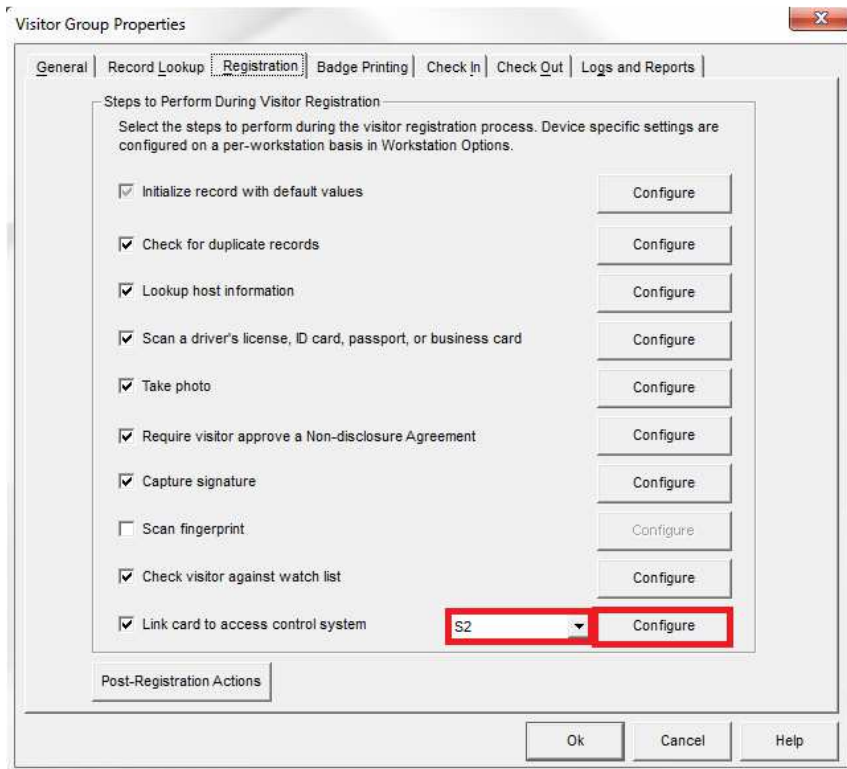

5. Configure the software by referencing the settings retrieved from your S2 system.

The screenshot shows the 'Access Manager' window with the 'Login' tab selected. The window title is 'Access Manager' and the subtitle is 'Lobby Track <--> S2'. The 'Login' tab is active, and the 'Settings' tab is also visible. The 'Login' button is highlighted with a red box. The form contains the following fields:

- NetBox IP Address:
- Port:
- User Name:
- Password:

Below the fields is a 'Login' button. At the bottom of the window are 'Save' and 'Cancel' buttons.

6. Open the Settings tab.

The screenshot shows the 'Access Manager' window with the 'Settings' tab selected. The window title is 'Access Manager' and the subtitle is 'Lobby Track <--> S2'. The 'Settings' tab is active and highlighted with a red box. The form contains the following fields:

- NetBox IP Address:
- Port:
- User Name:
- Password:

Below the fields is a 'Login' button. At the bottom of the window are 'Save' and 'Cancel' buttons.

7. Map the database fields between the Jolly Technologies software and the S2 system.

Access Manager

Lobby Track <--> S2

Login Settings

Select the S2 Card Format and Access Level that visitors will be assigned and map the S2 group fields to Lobby Track record fields. When a record is saved in Lobby Track, the mapped values will be sent to the S2 NetBox.

S2 Card Format:

S2 Access Level:

| S2 Fields       | Lobby Track Visitor Fields |
|-----------------|----------------------------|
| S2 Record ID:   | <input type="text"/>       |
| Hot Stamp:      | <input type="text"/>       |
| Encoded Number: | <input type="text"/>       |
| First Name:     | <input type="text"/>       |
| Middle Name:    | <input type="text"/>       |
| Last Name:      | <input type="text"/>       |
| Start Date:     | <input type="text"/>       |
| End Date:       | <input type="text"/>       |

Save Cancel

8. Click the Save button.

Access Manager

Lobby Track <--> S2

Login Settings

Select the S2 Card Format and Access Level that visitors will be assigned and map the S2 group fields to Lobby Track record fields. When a record is saved in Lobby Track, the mapped values will be sent to the S2 NetBox.

S2 Card Format:

S2 Access Level:

| S2 Fields       | Lobby Track Visitor Fields |
|-----------------|----------------------------|
| S2 Record ID:   | <input type="text"/>       |
| Hot Stamp:      | <input type="text"/>       |
| Encoded Number: | <input type="text"/>       |
| First Name:     | <input type="text"/>       |
| Middle Name:    | <input type="text"/>       |
| Last Name:      | <input type="text"/>       |
| Start Date:     | <input type="text"/>       |
| End Date:       | <input type="text"/>       |

Save Cancel

9. Click the Ok button.

